

5.

4. To record a symptom, press the Plus button to display the New Event screen. Use the arrows on the bottom left and right of the display to follow the instructions.

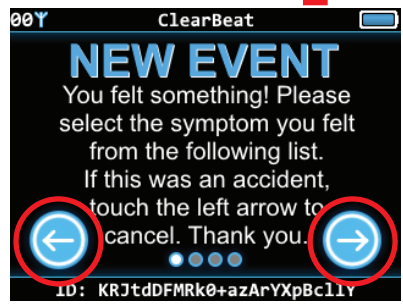

5. Use the up and down arrows to highlight the symptom and activity you would like to record.



6.

6. Once the symptom and activity have been selected, press the plus button to confirm the event and continue monitoring.



CHARGING YOUR DEVICE

Charge your device by inserting the barrel jack charger into an outlet then into the charging port on the lead cable. It is recommended to charge your device for 1 hour each day.

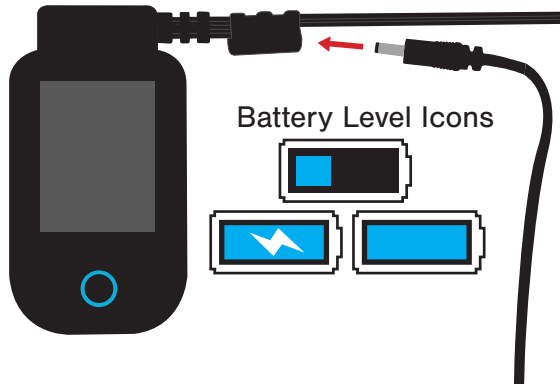

END OF STUDY

Power off the device by pressing the power icon in the lower-left of the Done Monitoring screen. Press the power icon to confirm shutdown, and return your monitoring device as soon as possible.

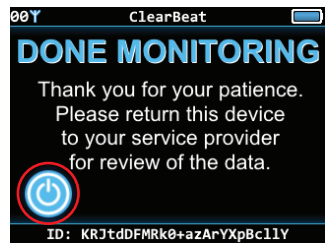

1.



Trident Pro Monitor

PATIENT: _____

AGE: _____ SEX: _____ MRN: _____

INDICATIONS: _____

ICD/PACEMAKER: YES _____ NO _____

MEDICATIONS: _____

START DATE/TIME: _____

WEAR TIME: _____ Days

PHYSICIAN: _____

MONITOR SERIAL #: _____



2. SCAN THE QR CODE BELOW TO WATCH OUR APPLICATION VIDEO.



SKIN PREP INSTRUCTIONS

1. In the areas shown in the diagram below, remove any hair and thoroughly clean the skin using one of the provided alcohol wipes in your kit.

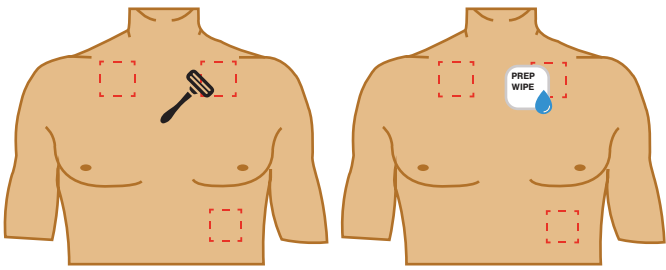

2. Once the area is dry, locate one of the provided abrasion pads and remove the release liner exposing the adhesive. Adhere the pad to your index finger.

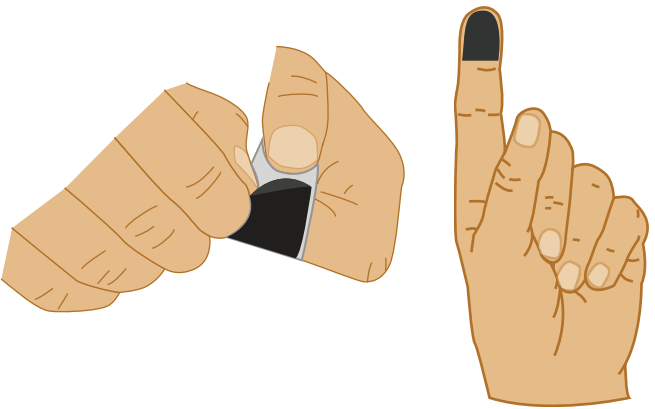

3.

3. Abrade the skin by applying pressure with your index finger and scrubbing the area up and down 5-6 times. Ensure to abrade all 3 areas where the electrodes will be placed.

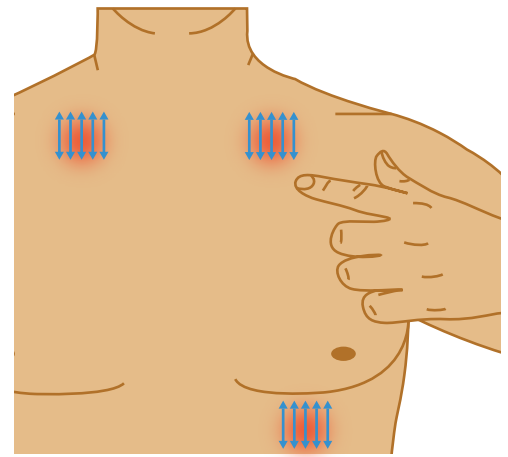

4. Clean each debrided area a final time, and allow each site to dry for 1 minute before applying the electrodes.

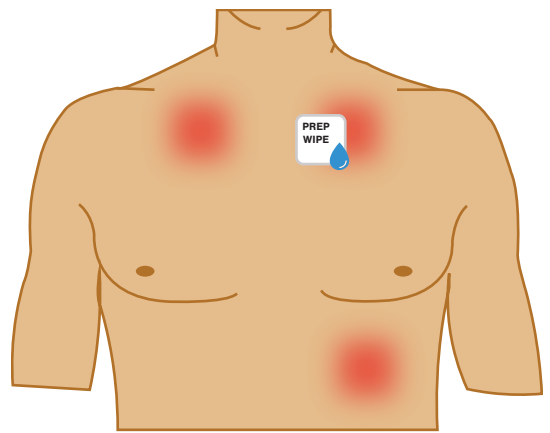

4.

STARTING YOUR STUDY

1. Remove the patient cable from the kit, and open the pack of adhesive electrodes. Attach each lead to one electrode.

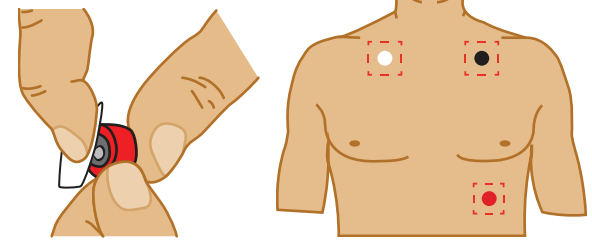

2. Peel the release liner to expose the adhesive, and apply each electrode to the cleaned and prepped sites indicated below. **Electrodes should be changed every 2-3 days.**

White = your right
Black = your left
Red = your left rib cage, below the Black lead

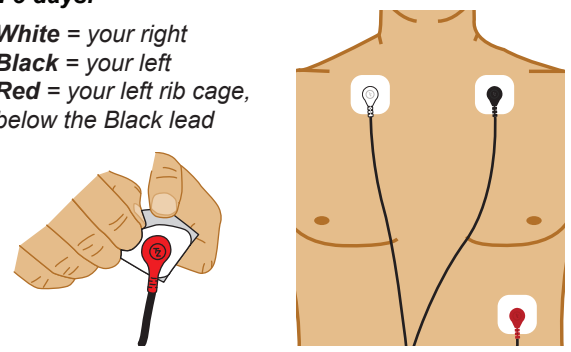

3. Power on the device by pressing and holding the button beside the screen. Select the + button to start the recording, then firmly connect the cable to the device in the orientation shown. ECG signal will display briefly before moving to the Monitoring screen.

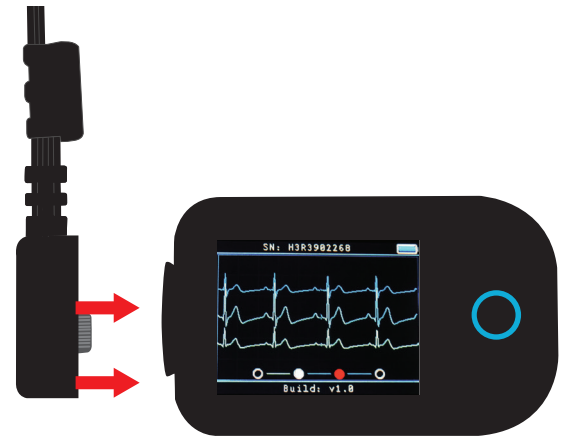

CUSTOMER SUPPORT

For assistance with your monitor, please call **800.338.1109**